

## MS-250 Steamer Operations

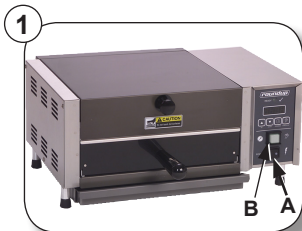

Turn unit on (A) and allow the unit to preheat for 20 minutes. Once the unit is preheated, press the green Operate button (B) once to test unit.

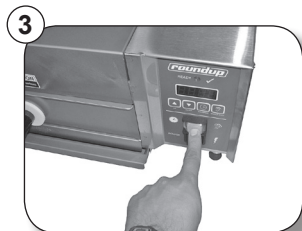

Push Spatula into unit fully and press the green Operate button to begin steaming. Refer to Owner's Manual 1010699 for programming instructions.

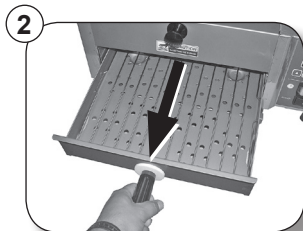

Remove Spatula and load food product.

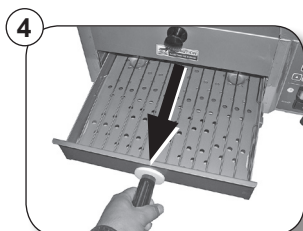

When steaming is finished and the unit stops beeping, remove Spatula and serve product.

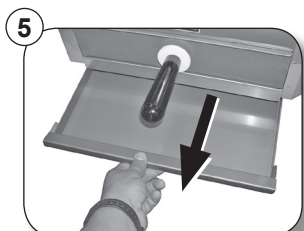

Periodically through the day, remove and empty Drip Pan and re-insert.

## MS-250 STEAMER OPERATIONS AND MAINTENANCE

### MS-250 Steamer Daily Maintenance

**NOTE:** Turn unit off and allow to cool to room temperature before proceeding.

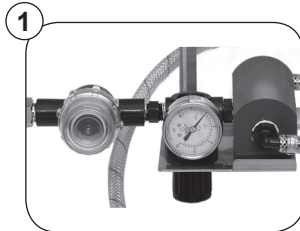

Water Pressure Regulator must read 20 to 25 PSI. Inspect fittings & hoses for leaks. See Owner's Manual if adjustments are needed. Then, remove Spatula as shown in step 2.

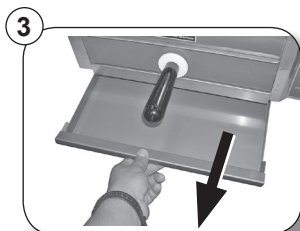
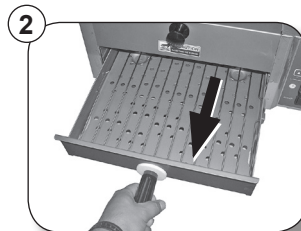

Remove Drip Pan.

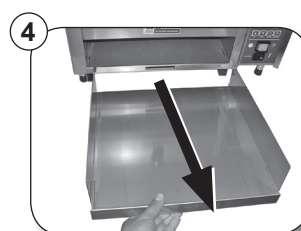

Remove Liner by lifting up and out of unit.

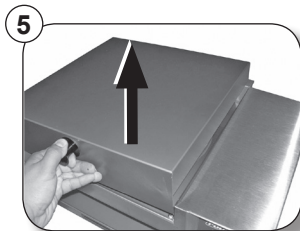

Remove Top Cover.

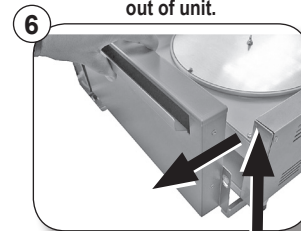

Remove rear Steam Vent by lifting up and away from back of unit. Wash all items removed in Steps 2 - 6 in soapy water. Dry with clean cloth.

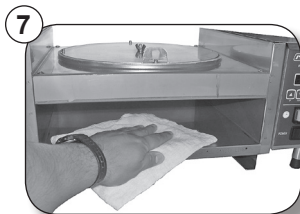

Wipe ENTIRE unit with a clean, damp cloth. Wipe dry with a dry cloth.



Re-assemble unit. Daily Maintenance is complete. Note: Do **NOT** reassemble unit when performing Weekly Maintenance.

### MS-250 Steamer Weekly Maintenance

**NOTE:** Perform the daily maintenance before beginning this procedure. Do not re-assemble unit as you will need to access



With the Spatula, Drip Pan, Liner, Top Cover, and rear Steam Vent removed, remove the Generator Cover wing nut and remove the Generator Cover.

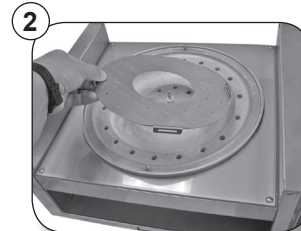

Remove the Diffuser Plate and inspect the Generator.



Inspect all 26 generator holes and the two side water injection holes. They should **NOT** be plugged.

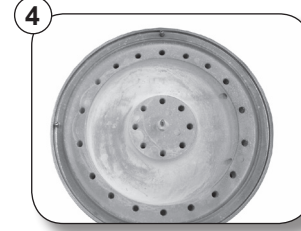

Clean generators have some scale deposits, which is normal. The holes will **NOT** be plugged.

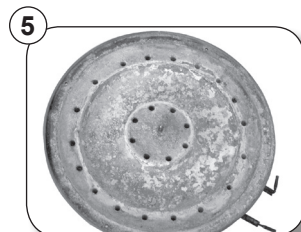

Dirty generators have excessive deposits that must be removed (see Owner's Manual 1010699).

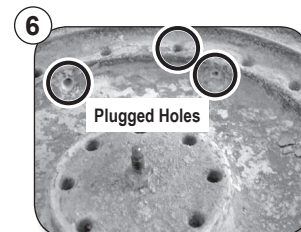

**EXAMPLE:** Close-up of a Generator with excessive scale deposits. The holes are plugged and should be cleaned according to Owner's Manual 1010699.

**NOTE:** If the generator is clean (Figure 4), reassemble the unit and place it back into service. If the generator requires cleaning, follow the procedure located in the Maintenance section of Owner's Manual 1010699.